

# Fuel Pressure Regulator Mini 2



- ▶ 5 to 8 bar
- ▶ 30 to 400 l/h reflow
- ▶ Adjusted at 105 l/h
- ▶ Aluminum housing
- ▶ All versions Methanol compatible

Fuel pressure regulators are used to maintain constant fuel pressure at the injection valves.

We offer this regulator for gasoline as well as for methanol applications.

The main benefit of this regulator includes a higher pressure range and a higher return flow rate in comparison to the production type regulators.

## Application

Pressure range	See ordering information
Reflow quantity	30 to 400 l/h
Fuel compatibility	Gasoline, E85, M100
Operating temperature	-40 to 120°C
Storage temperature	-40 to 100°C
Max. vibration	<600 m/s <sup>2</sup> at 5 to 250 Hz
Valve leakage	$Q_{leak} [cm^3/min] \leq 9$ (pneumatic) at $p [kPa] = 0.8 \times P_{nom}$

## Technical Specifications

### Mechanical Data

Diameter	38.1+0.1-0.2 mm
Weight	Ca. 61 g
Mounting	Fastening with a clip

### Connectors and Wires

Connector supply	Diam. 25 mm, O-ring 25x2.5
Connector reflow	Diam. 9.1 mm, O-ring 5x2.5

## Installation Notes

Never run the regulator without the integrated filter.

Please oil O-rings lightly with clean and silicone free engine oil before you install the regulator.

Please make a leak test after you have installed the regulator.

When the pressure regulator is removed and will be reused, the O-rings must be tested for fractures.

Operation of the pressure regulator with a medium other than gasoline is not allowed.

Using the FPR Adaptor light F02U.V02.248-01, you can rebuild the regulator an inline type.

This pressure regulator is not designed for in-tank mounting.

## Legal Restrictions

Due to embargo restrictions, sale of this product in Russia, Belarus, Iran, Syria, Libya, Afghanistan, and North Korea is prohibited.

## Ordering Information

### Fuel Pressure Regulator Mini 2

Pressure Range 5.0 bar  
Order number **F02U.V02.166-01**

### Fuel Pressure Regulator Mini 2

Pressure Range 6.0 bar  
Order number **F02U.V02.168-01**

### Fuel Pressure Regulator Mini 2

Pressure Range 7.0 bar  
Order number **F02U.V02.170-01**

### Fuel Pressure Regulator Mini 2

Pressure Range 8.0 bar  
Order number **F02U.V02.171-01**

## FPR Adaptor light

Order number **F02U.V02.248-01**

## Dimensions

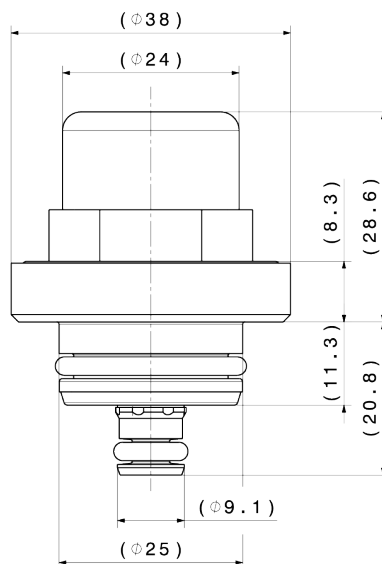

## Represented by:

**Europe:**  
Bosch Engineering GmbH  
Motorsport  
Robert-Bosch-Allee 1  
74232 Abstatt  
Germany  
motorsport@bosch.com  
www.bosch-motorsport.de

**North America:**  
Bosch Engineering North America  
Motorsport  
38000 Hills Tech Drive  
Farmington Hills, MI 48331-3417  
United States of America  
motorsport@bosch.com  
www.bosch-motorsport.com

**Asia-Pacific:**  
Bosch Engineering Japan K.K.  
Motorsports Department  
1-9-32 Nakagawachuo, Tsuzuki-ku  
Yokohama-shi  
Kanagawa, 224-8601  
Japan  
motorsport@jp.bosch.com  
www.bosch-motorsport.jp

**Australia, New Zealand and South Africa:**  
Robert Bosch Pty. Ltd  
Motorsport  
1555 Centre Road  
Clayton, Victoria, 3168  
Australia  
motor.sport@au.bosch.com  
www.bosch-motorsport.com.au